

Wing Nut

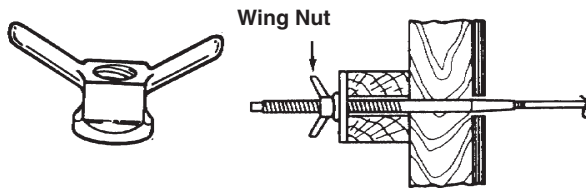

Wing Nuts are available in 1/2" through 1-1/2" diameters. Wing Nuts are normally supplied with coil threads. Acme thread is available on special order. Wing nuts are typically used with she-bolts, he-bolts, taper ties and through bolting in heavy forming applications

Batter Washer

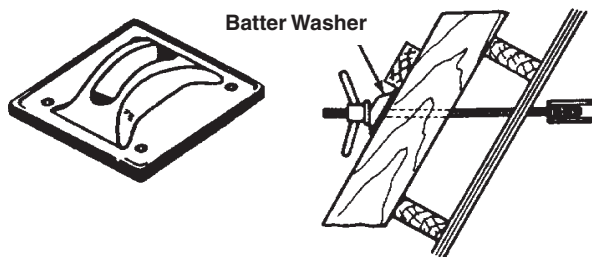

Batter Washers are designed to swing freely to any desired angle up to 45°. They are available in 1/2" through 1-5/8" diameters. Nail holes permit nailing to the waler and multiple grips on the underside help prevent slippage.

Flared Coil Loop Inserts

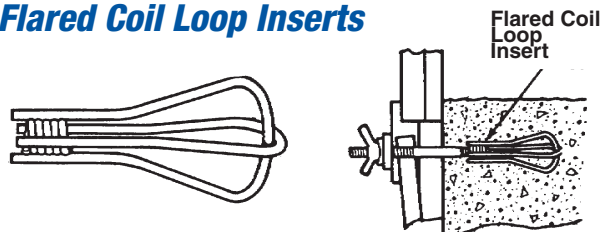

Flared Coil Loop Inserts are used with coil thread bolts to effectively anchor formwork. Available in several configurations with 3/4", 1", 1-1/4" and 1-1/2" diameter coil thread.

Crimped Pigtail Anchor

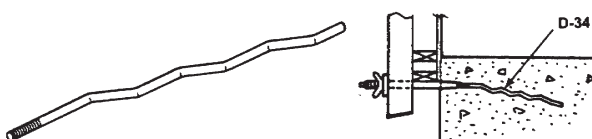

Crimped Pigtail Anchors are used for forming anchorage in mass concrete. Manufactured in 1/2" through 1" diameters with either coil or NC machine thread.

Four Strut Coil Insert

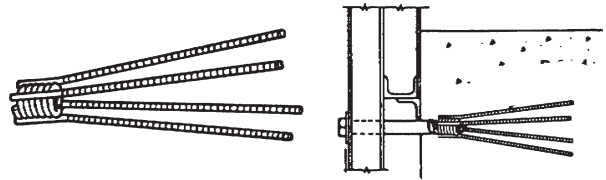

Four Strut Coil Inserts combine the advantages of the coil tie and continuous threaded coil rod to make a highly effective form anchorage.

Adjustable Weld Angle Bracket

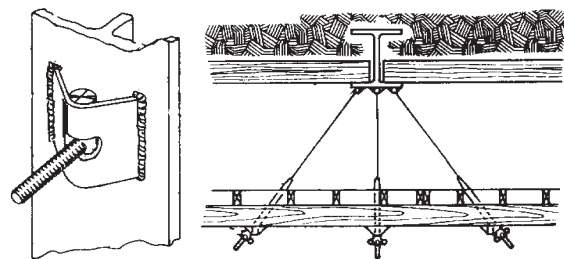

Adjustable Weld Angle Brackets are designed to tie single-sided forming to steel piles, metal beams, etc. The brackets provide 110° of bolt adjustability and are available in 1/2", 3/4" and 1" diameters.

Rock Anchor

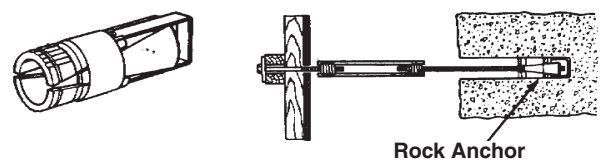

Rock Anchors are designed for use in sound rock or concrete to secure one-sided forming. Available in 1/2", 3/4" and 1" nominal diameters.